



Advent House, Isaac Way, Manchester  
Offers In Excess Of £265,000

**Ascend**  
Built on higher standards

## Advent House, Isaac Way, Manchester

Welcome to Advent House, a stunning penthouse apartment located on Isaac Way in the vibrant city of Manchester. This modern property, built in 2003, offers a perfect blend of comfort and convenience, making it an ideal choice for families or professionals seeking a stylish urban lifestyle.

The apartment boasts three spacious double bedrooms, providing ample space for relaxation and privacy. With two well-appointed bathrooms, morning routines will be a breeze, ensuring that everyone has their own space. The heart of the home is a welcoming reception room, perfect for entertaining guests or enjoying quiet evenings in.

One of the standout features of this property is the expansive terrace and balcony, offering delightful outdoor space to unwind and enjoy the views of the surrounding area. Whether you wish to sip your morning coffee in the sun or host a summer gathering, this outdoor area is sure to impress.

Convenience is key, and this apartment does not disappoint. It comes with a designated parking space, making it easy to navigate the city and beyond. The location is superb, with excellent motorway links nearby, ensuring that commuting is hassle-free. Additionally, a variety of shops and amenities are just a stone's throw away, providing everything you need within easy reach.

In summary, this penthouse apartment at Advent House is a remarkable opportunity to enjoy modern living in a prime Manchester location. With its generous living space, outdoor areas, and convenient access to transport and local amenities, it is a property not to be missed.

### Non-Qualifying Lease

Please Note: this property will have a Non-Qualifying Lease

(<https://www.gov.uk/guidance/remediation-costs-what-leaseholders-do-and-do-not-have-to-pay> Point 30)



Please note that we have not tested any apparatus, equipment, fixtures, fittings or services, and so cannot verify they are in working order or fit for their purpose. Furthermore solicitors should confirm moveable items described in the sales particulars are, in fact, included in the sale since circumstances do change during marketing or negotiations. A final inspection prior to exchange of contracts is also recommended. Although we try to ensure accuracy, measurements used in this brochure may be approximate. Therefore if intending purchasers need accurate measurements to order carpeting or to ensure existing furniture will fit, they should take such measurements themselves.



GROUND FLOOR

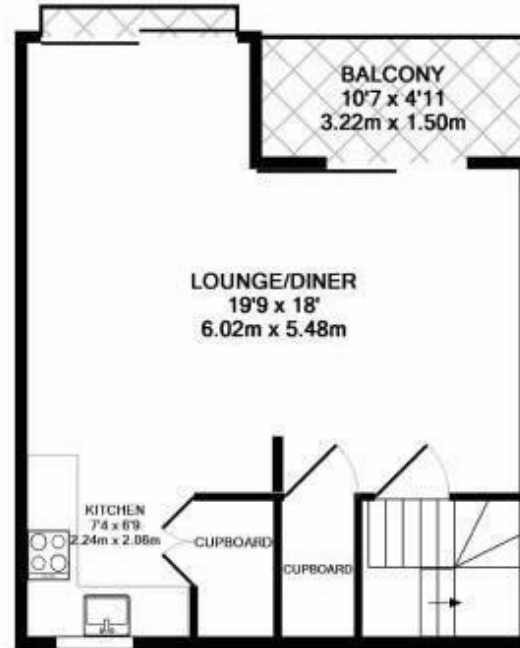

1ST FLOOR

Whilst every attempt has been made to ensure the accuracy of the floor plan contained here, measurements of doors, windows, rooms and any other items are approximate and no responsibility is taken for any error, omission, or mis-statement. This plan is for illustrative purposes only and should be used as such by any prospective purchaser. The services, systems and appliances shown have not been tested and no guarantee as to their operability or efficiency can be given.  
Made with Metropix ©2018

